

LOT STATUS KEY

- ACTIVE LISTING
- PENDING LOT SALE
- LOT SOLD

LOT TYPE KEY

- WO** - Walkout Lot allows access to the backyard from the lower level. The grade slopes down and away from the front-yard enough to allow for above grade lower level exterior.
- LO** - Lookout Lot allows for windows to be at or above grade out the back of the home.
- FB** - Full Basement lot meaning the Lower Level windows will be at or below grade and require window wells.
- CG** - Custom Grade. For Custom Lots, please contact the Realtor at (952) 412-8713 or email to info@MNHomeRealtyGroup.com for more details.

For More Information

WyndhamHillsMN.com

(952) 412-8713 | info@MNHomeRealtyGroup.com

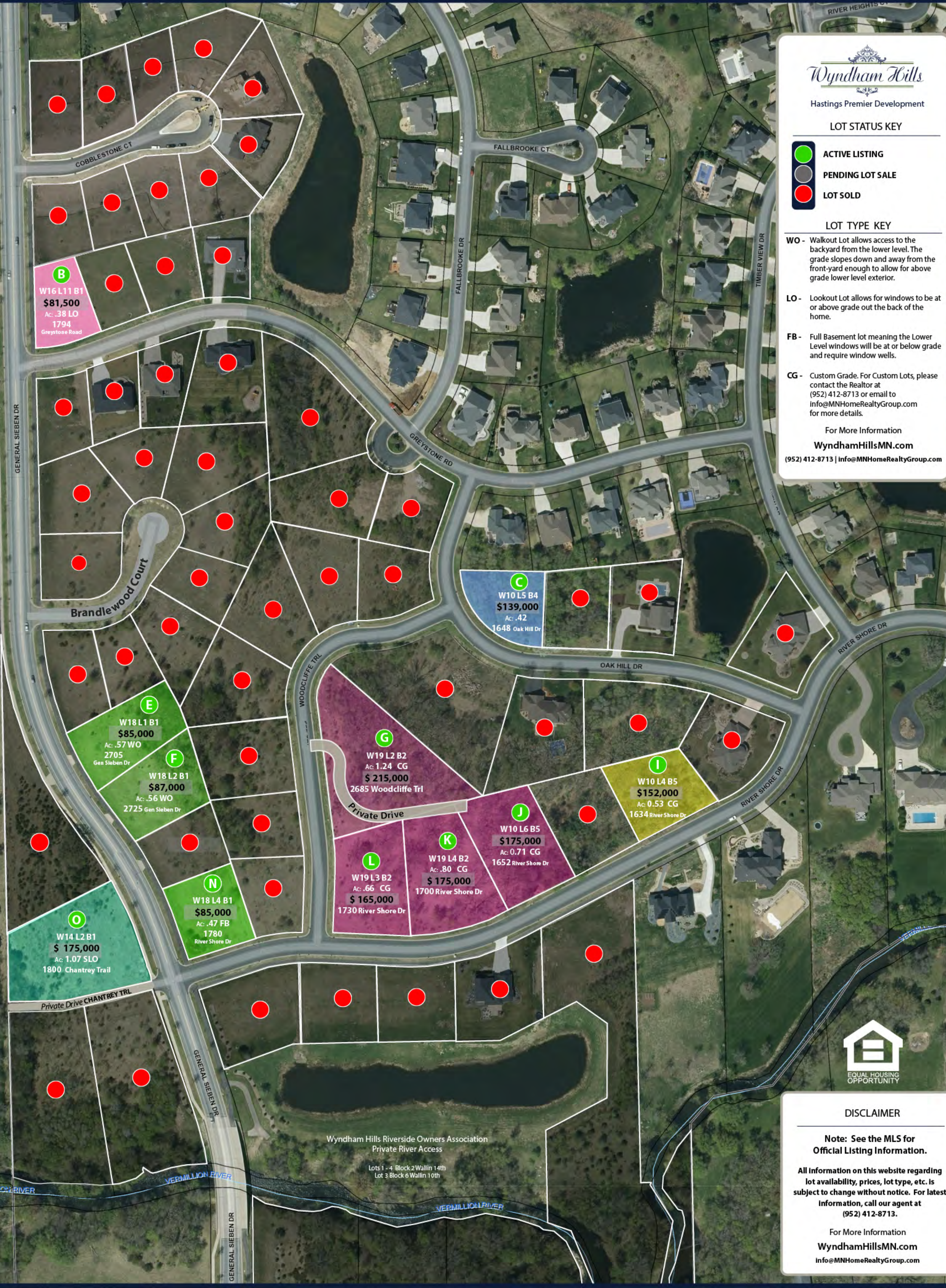

B
W16 L1 B1
\$81,500
Ac: .38 LO
1794
Greystone Road

C
W10 L5 B4
\$139,000
Ac: .42
1648 Oak Hill Dr

E
W18 L1 B1
\$85,000
Ac: .57 WO
2705
Gen Sieben Dr

F
W18 L2 B1
\$87,000
Ac: .56 WO
2725 Gen Sieben Dr

G
W19 L2 B2
Ac: 1.24 CG
\$ 215,000
2685 Woodcliffe Trl
Private Drive

I
W10 L4 B5
\$152,000
Ac: 0.53 CG
1634 River Shore Dr

J
W10 L6 B5
\$175,000
Ac: 0.71 CG
1652 River Shore Dr

L
W19 L3 B2
Ac: .66 CG
\$ 165,000
1730 River Shore Dr

K
W19 L4 B2
Ac: .80 CG
\$ 175,000
1700 River Shore Dr

N
W18 L4 B1
\$85,000
Ac: .47 FB
1780
River Shore Dr

O
W14 L2 B1
\$ 175,000
Ac: 1.07 SLO
1800 Chantrey Trail
Private Drive CHANTREY TRL

Wyndham Hills Riverside Owners Association
Private River Access

Lots 1 - 4 Block 2 Wallin 14th
Lot 3 Block 6 Wallin 10th



DISCLAIMER

Note: See the MLS for Official Listing Information.

All information on this website regarding lot availability, prices, lot type, etc. is subject to change without notice. For latest information, call our agent at (952) 412-8713.

For More Information

WyndhamHillsMN.com

info@MNHomeRealtyGroup.com